

GENERAL DIMENSIONAL TOLERANCES OF WORKING ON GRANITE UNLESS OTHERWISE SPECIFIED (THEREFORE EXCLUDED THE TITLE BLOCK TOLERANCES)

Catalogue 13 | Page 6

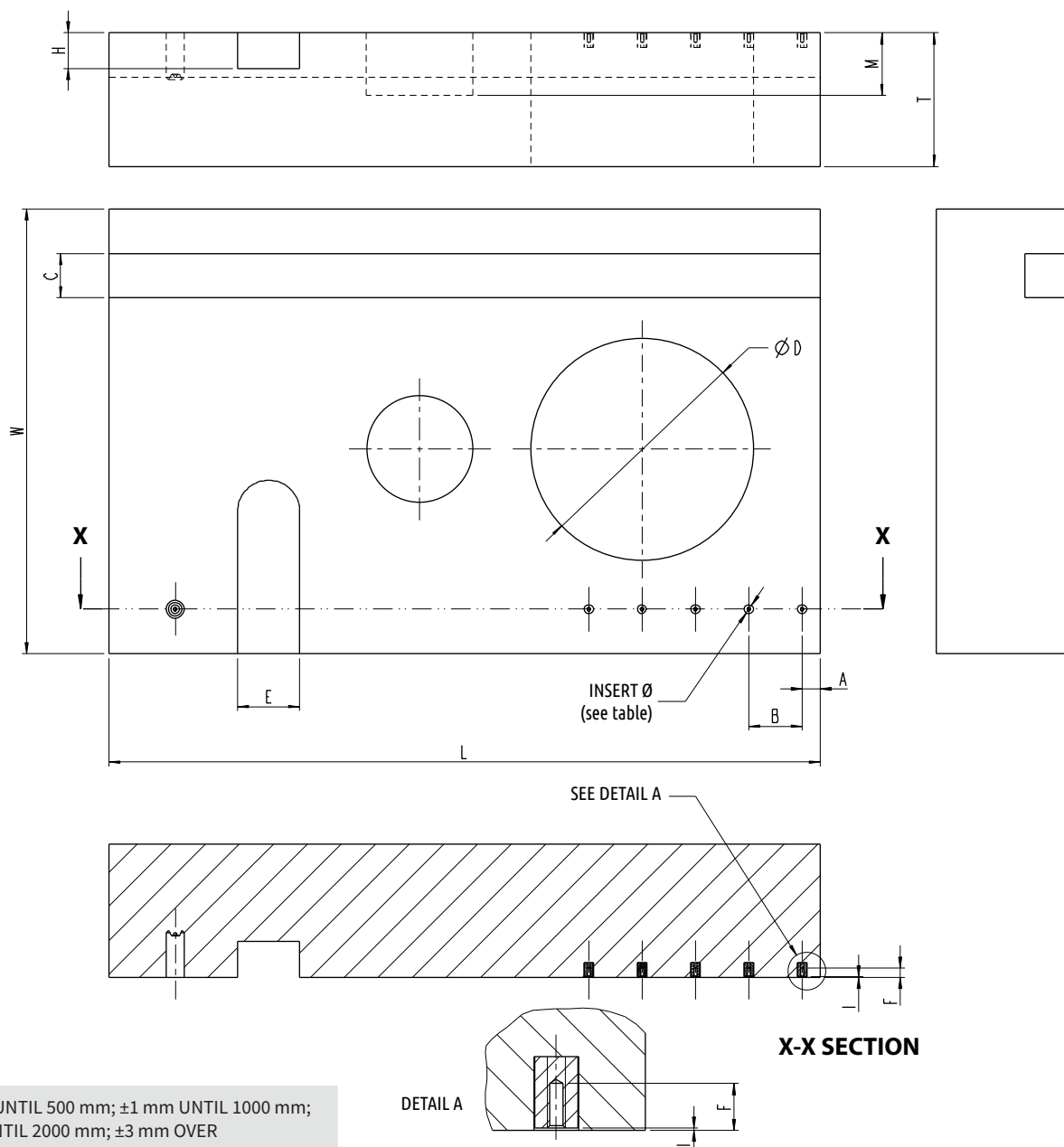

L ±0.5 mm UNTIL 500 mm; ±1 mm UNTIL 1000 mm;
±2 mm UNTIL 2000 mm; ±3 mm OVER

W ±0.5 mm UNTIL 500 mm; ±1 mm UNTIL 1000 mm;
±2 mm UNTIL 2000 mm; ±3 mm OVER

T ±2 mm UNTIL 300 mm; ±3 mm OVER

I FROM 0.3 TO 1 mm

F THREAD DEPTH 0/+2 mm

A* 1.5 MIN. x INSERT Ø (SEE INSERTS TABLE)
START ±0.2 mm

B 1.2 MIN. x INSERT Ø (SEE INSERTS TABLE)
CENTRE DISTANCE ±0.2 mm

D ±1 mm; ±2 mm OVER 200

M ±1 mm

C ±1 mm

E ±1 mm

H ±1 mm

DETAIL A

* The start of the holes from the edge (A dimension), if the adjacent surface is ground, has a tolerance of ±0.2 mm; if the adjacent surface is rough or polished, it will depend on the geometry of the piece.



Download
Technical Annexes



MPG/Annex_18.indd | Vers. 18.0

Drw. M.110707.000